

# 25 SERIAL. GEAR PUMP

# ISO

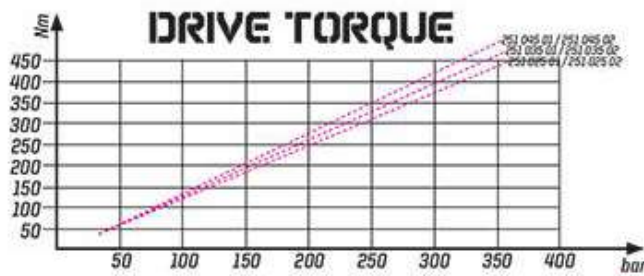

Fluid Temp. °C	Input Pres. Bar	Optimale K. Viscosity	Oil Filtering
0 / 100	0,3 / 1,7 bar	10 / 100 CST	> 200 bar : 25 µm < 200 bar : 35 µm

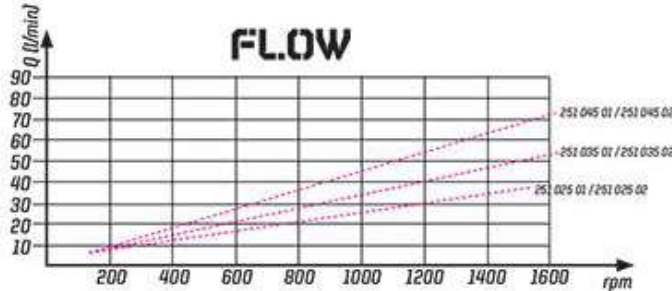
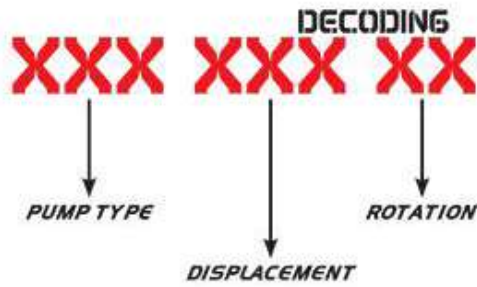
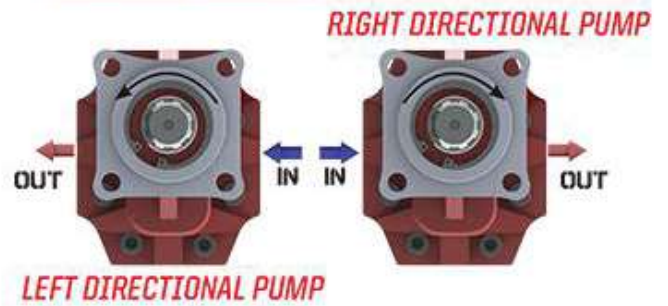

**NOTE :** THE ABOVE SPECIFICATIONS REFER TO OIL TYPE ISO VG 46 AT 50°

**NOTE :** SEE TECHNICAL PAGE TO CHANGE THE DIRECTION OF ROTATION

**USED PLACED :**  
DUMPER TRUCKS  
PRIVATE AIM WINCHES  
TRACTOR LADLES

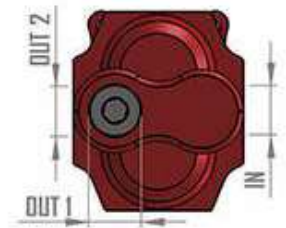
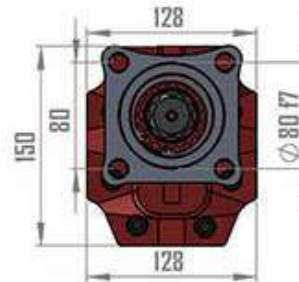
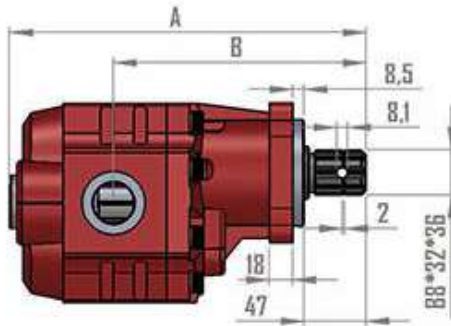

Code	Displacement cm <sup>3</sup> /1000	Rotation	Test Pressure	Max. Test Pressure	A	B	Oil Inlet	Oil Outlet	Max. Con. Speed Rpm	Max. Inter. Speed Rpm	Weight
251 025 01	25,8	Right	220	240	222	167	G 1"	G 3/4"	2450	2500	12,5
251 025 02	25,8	Left	220	240	222	167	G 1"	G 3/4"	2450	2500	12,5
251 035 01	35,4	Right	215	235	228	170	G 1"	G 3/4"	2450	2500	13
251 035 02	35,4	Left	215	235	228	170	G 1"	G 3/4"	2450	2500	13
251 045 01	45,2	Right	200	220	234	173	G 1"	G 3/4"	2400	2500	13,5
251 045 02	45,2	Left	200	220	234	173	G 1"	G 3/4"	2400	2500	13,5

Test Pressure : 60 sec

Max Test Pressure : 5 sec. Max.